

How To Enable SMTP Authentication on Windows Authentication on Windows Guide

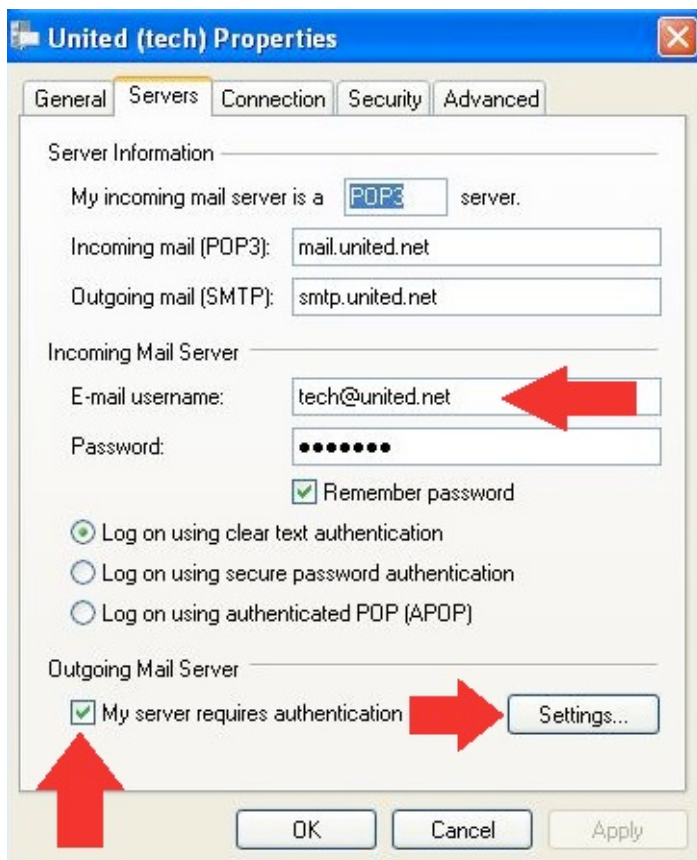

Windows Mail

- Click the **Tools** menu.
- Click **Accounts**.
- Select your email account, and then click **Properties**.
- Click the **Servers** tab.
- Under **Incoming Mail Server** in the field labeled **Email Username** enter your full email address.
- Put a check next to "**My server requires authentication**"
- Click the **Settings** button.
- Select the option next to "**Use same settings as my incoming mail server**"



Note: Outgoing Mail Server window becomes active once selecting the **Settings** button.

Outlook Express (Windows 95/98/ME/2000/XP) & Outlook 2000+

- Click the **Tools** menu.
- Click **Accounts**
- Select your email account, and then click **Properties**.
- Click the **Servers** tab.
- Under **Incoming Mail Server** in the field labeled **Account Name** enter your full email address.
- Put a check next to "**My server requires authentication**"
- Click the **Settings** button.
- Select the option next to "**Use same settings as my incoming mail server**"

(See Below)

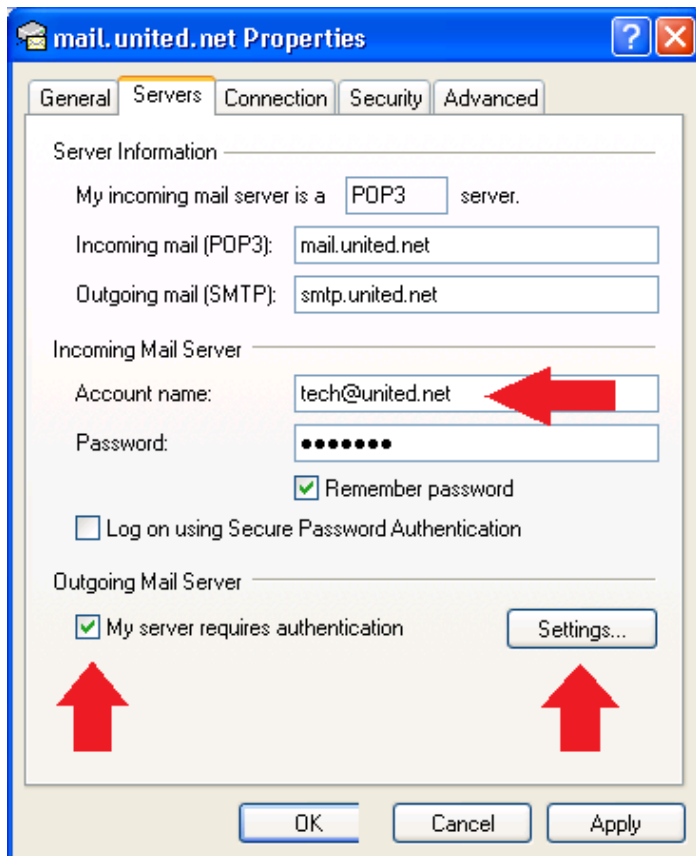

Note: Outgoing Mail Server window becomes active once selecting the **Settings** button.

Mozilla Thunderbird

- Click the email address in the panel on the left.
- Click "**View settings for this account.**"
- Click **Outgoing Server (SMTP)** in the panel on the left.
- Select your United Communication's email account.

- Click **Edit**.
- Change **Authentication method** to **Password, transmitted insecurely**
- In the field labeled **User Name** enter your full email
(See Below)

